



75 Battersea Park Road, Nine Elms
London SW8

GARTONJONES.COM



75 Battersea Park Road, Nine Elms
London, SW8

GARTON JONES.COM

9 Albert
Embankment
London
SE1 7SP

Lettings:
+44 (0) 20 7735 1888
nineelms@gartonjones.com
www.gartonjones.com

£550 Per Week

A beautifully furnished, bright and spacious 2 double bedroom, 2 bathroom (1 en-suite) apartment on in this purpose-built development in the heart of the Nine Elms. Includes Heating and Hot water. The apartment comprises an open plan reception room, modern integrated kitchen, wood flooring, 24 hour concierge, communal roof terrace with fantastic city views, residents gymnasium and a large private balcony. The rail/tube links of Vauxhall are moments away and the beautiful green open spaces of Battersea Park are on the doorstep. Secure parking included.

- 646 sq.ft
- 2 Bedrooms
- 2 Bathrooms (1 En-Suite)
- Secure Parking
- Includes Heating and Hot Water
- Open Plan Reception Room
- Integrated Kitchen
- Wood Flooring
- 24 Hour Concierge
- Residents Gymnasium, Private Terrace With Great Views,



Approximate Gross Internal Area = 60 sq m / 646 sq ft

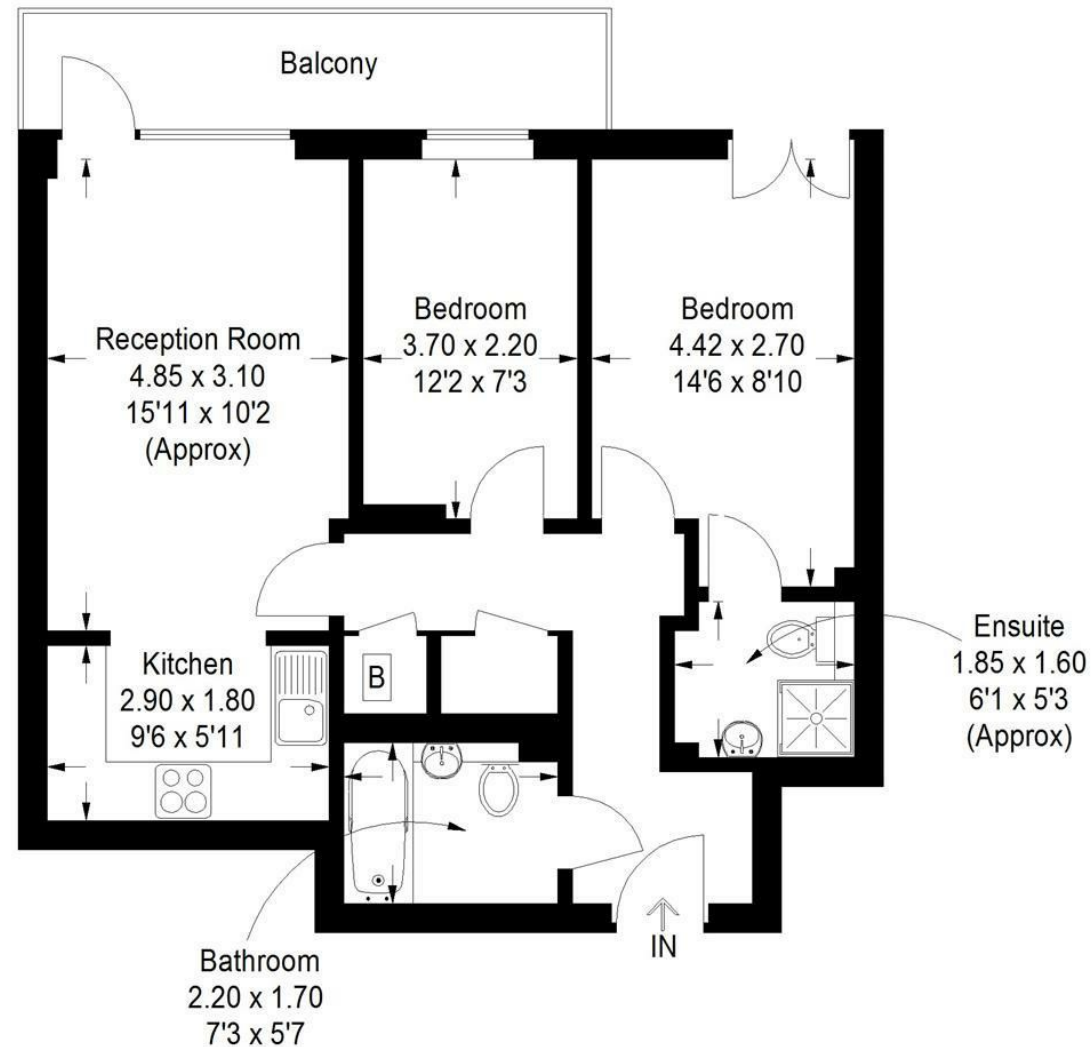

Illustration for identification purposes only, measurements are approximate, not to scale.

